

MODEL 2225PS



WARNING

WARNING — THE INSTALLATION MUST BE CARRIED OUT BY A QUALIFIED ELECTRICIAN.

1. LED Flush Mounts are suitable for using in wet locations
2. Please keep the LED Flush Mounts away from any corrosive substance, and please use dry cloth when you clean it
3. LED Flush Mounts can only be installed by a qualified electrician
4. Before installation or maintenance, please disconnect the power to prevent electric shock

Application Notice

1. Turn OFF the power supply at the fuse or circuit breaker box before you install the fixture
2. Ground the fixture to avoid potential electric shocks and to ensure reliable starting
3. Double-check all connections to be sure they are tight and correct
4. Wear rubber soled shoes and work on a sturdy wooden ladder
5. This fixture is designed for use in a circuit protected by a fuse or circuit breaker. The fixture is also designed to be installed in accordance with local electrical codes. If you are unsure about your wiring, consult a qualified electrician or local electrical inspector, and check your local electrical code
6. **WARNING — RISK OF CUTS:** Some metal parts in the fixture may have sharp edges. To prevent cuts and scrapes, wear gloves when handling the parts
7. Account for small parts and destroy packing material, as these may be hazardous to children
8. **DO NOT** change the LED light source or driver inside under any circumstance
9. **DO NOT** cover the fixture with any heat insulated materials
10. **WARNING — RISK OF FIRE:** Use 120V AC 50/60Hz

CAUTION

PLEASE READ INSTRUCTION BEFORE COMMENCING INSTALLATION AND RETAIN FOR FUTURE REFERENCES.

Electrical products can cause death or injury, or damage to property.

If in any doubt about the installation or use of this product, consult a competent electrician.

INSTALLATION GUIDE

Embedded in Installation

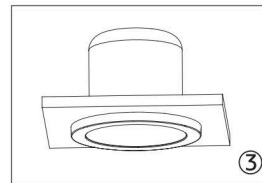
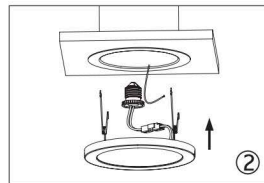
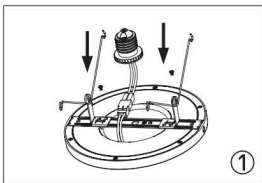

1. Remove trim and existing lamp from recessed fixture
2. Screw E26 socket adapter into socket in the housing
3. Press the friction blade to insert the lamp into the housing and restore power

Surface Mounting Installation

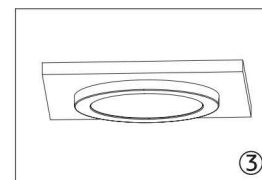
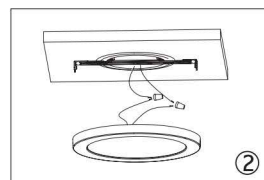
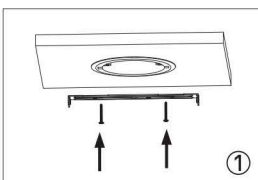

1. Fixing bracket on terminal box
2. Connecting the wire
3. Fixing the lamp body on bracket tightly

MODEL 2225PS

INSTALLATION GUIDE

How to Uninstall

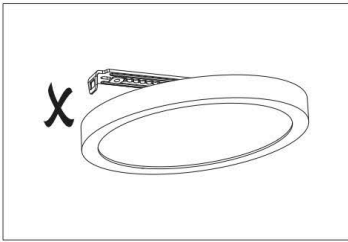

DON'T remove the fixture from any one side of the self-lock mounting strap. This may cause damage to the fixture

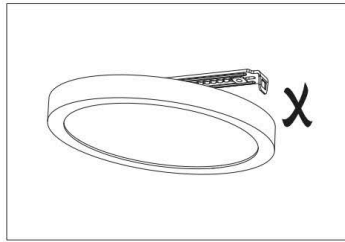

DON'T remove the fixture from any one side of the self-lock mounting strap. This may cause damage to the fixture

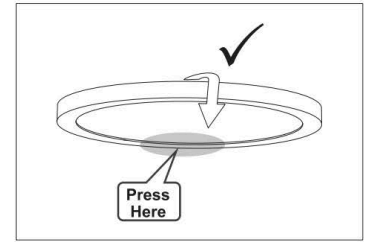

Press one side of the fixture frame (perpendicular to mounting strap then take out the fixture from the opposite side)

DAY & NIGHT SENSOR FUNCTION

Daylight Sensor Switch

Choose Day or Night mode via the switch located on the fixture body.

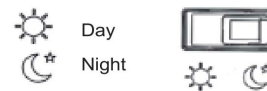

1. Daytime

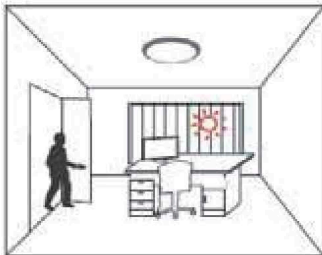

When the room is illuminated with natural light, the fixture will NOT turn on when someone enters the room.

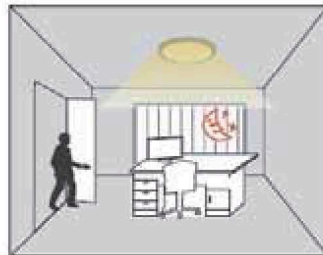

When no natural light is detected, the fixture will turn ON when someone enters the room.



The fixture will remain ON for 30 seconds, or until no motion is detected.



The fixture will remain in standby mode when no motion is detected.

2. Nighttime

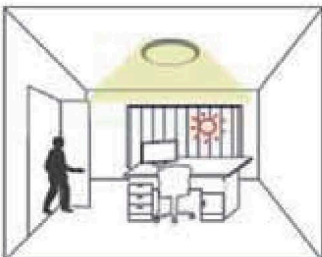

The fixture will turn ON when motion is detected, regardless of the presence of natural light.

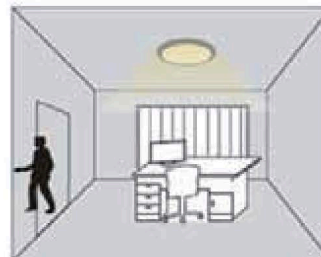
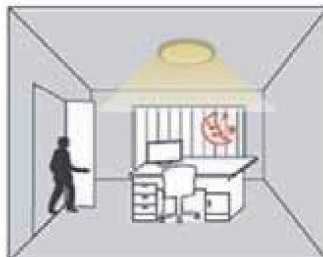

The fixture will remain ON for 30 seconds, or until no motion is detected.

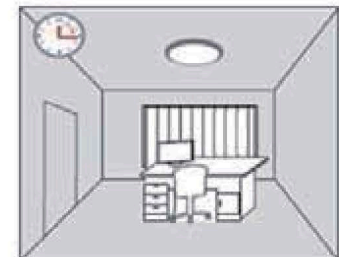

The fixture will remain in standby mode when no motion is detected.

ORTECH reserves the right to modify at any time, without notice, any or all of our product's features, designs, components and specifications to meet market changes.