

INSTALLATION INSTRUCTIONS



Area Light *JOVE (ALJ) Series*



These instructions are applicable for the following model(s):

- JOVE (ALJ) Series

TOOLS REQUIRED

- Philips Screw Driver
- Allen/Hex Key
- Wiring Supplies

MOUNTING OPTIONS

- Trunnion Mount
- Slipfitter Mount
- Universal Pole Mount
(via fixed or adjustable extruded arm)

INSTALLATION PROCEDURE

Switch off the power supply.

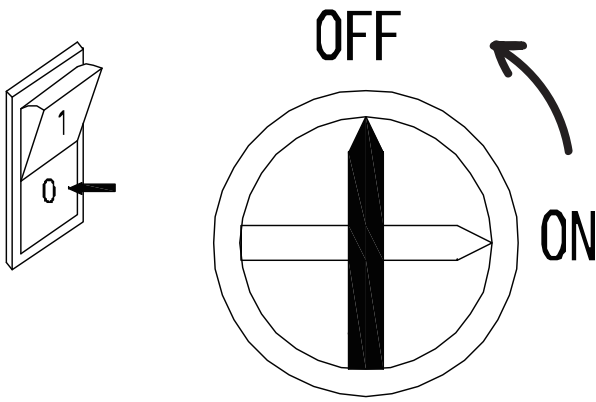

Trunnion Mount

1. Install the trunnion in the desired position on the the lamp pole.

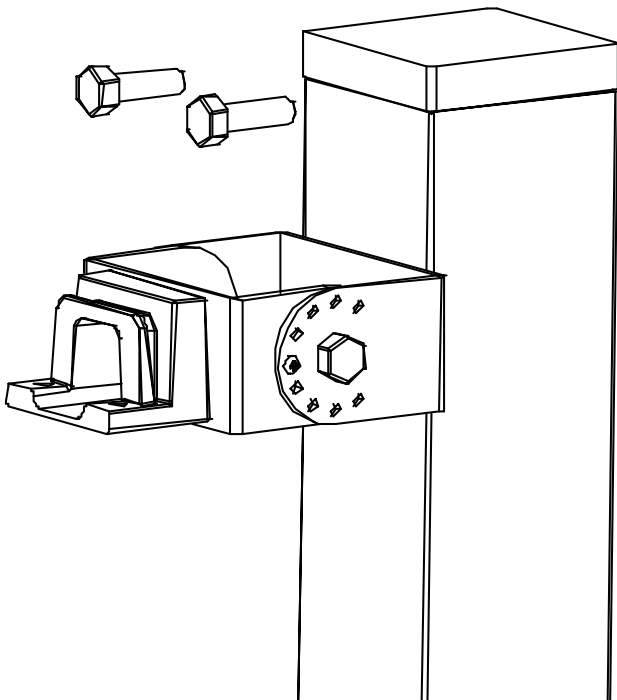

2. Install the light fixture on the trunnion.

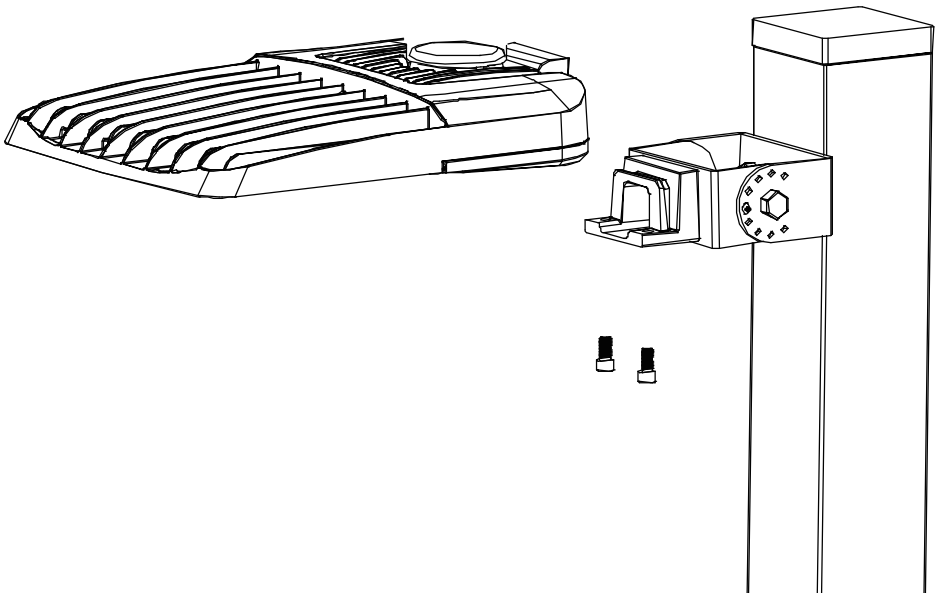

3. Open lower cover of the luminaire and complete wiring. Use suitable waterproof cord bushing and outlet box cover to maintain IP rating.

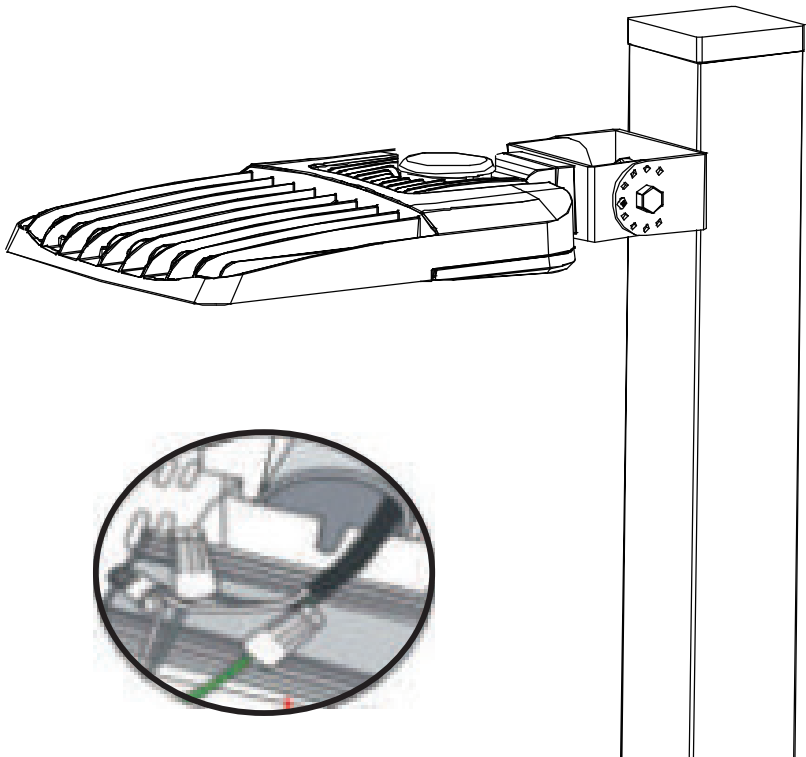

4. Switch on the power supply.

Slipfitter Mount

1. Attach the slipfitter to the luminaire.

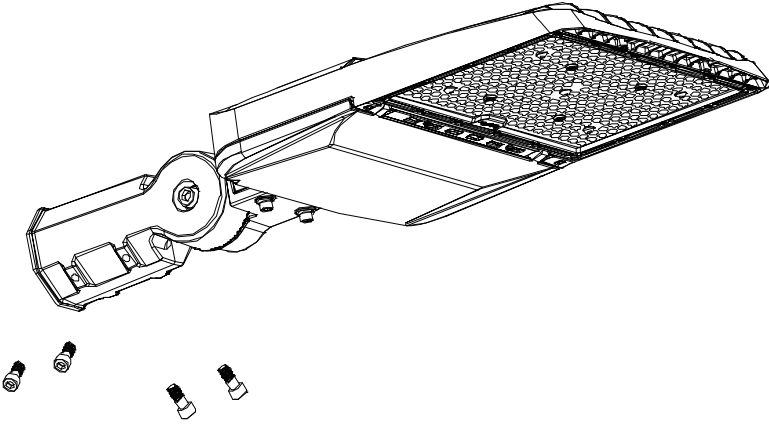

2. Connect the input wire and install the luminaire on the lamp pole.

Note: After lengthening the input wire, ensure the height requirements of the light pole are met, then connect the wire at the bottom of the lamp pole.

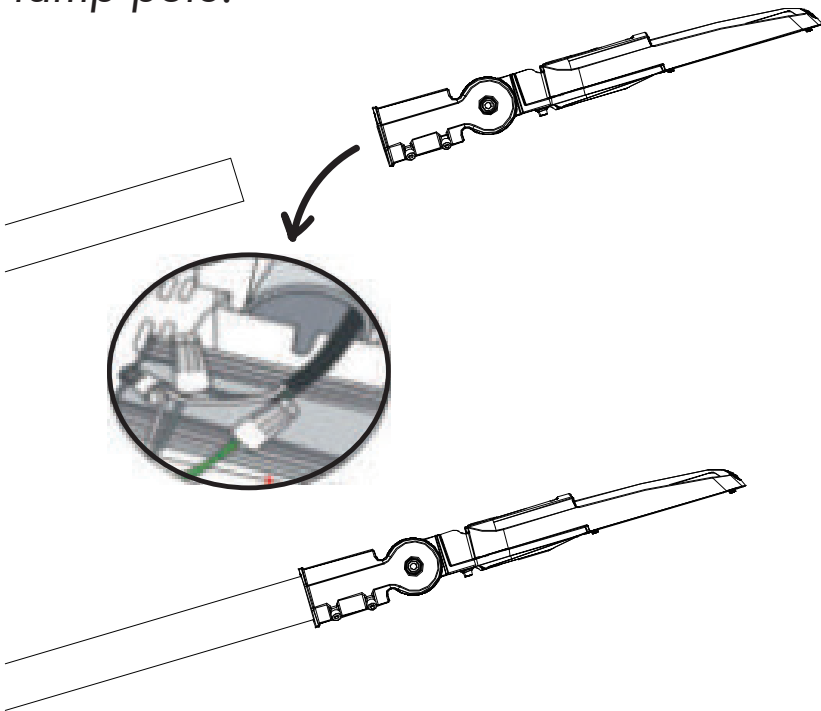

3. Switch on the power supply.

Universal Pole Mount

Via fixed extruded arm

1. Install the extruded arm in the desired position on the the lamp pole.

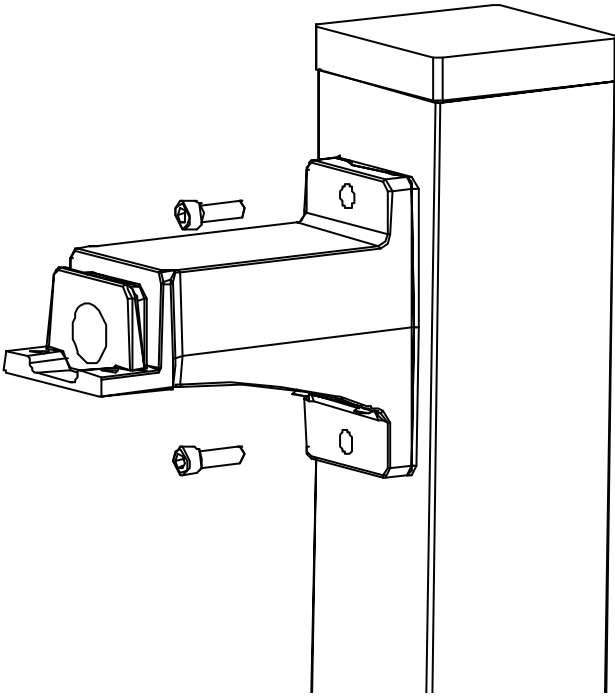

2. Install the light fixture on the extruded arm.

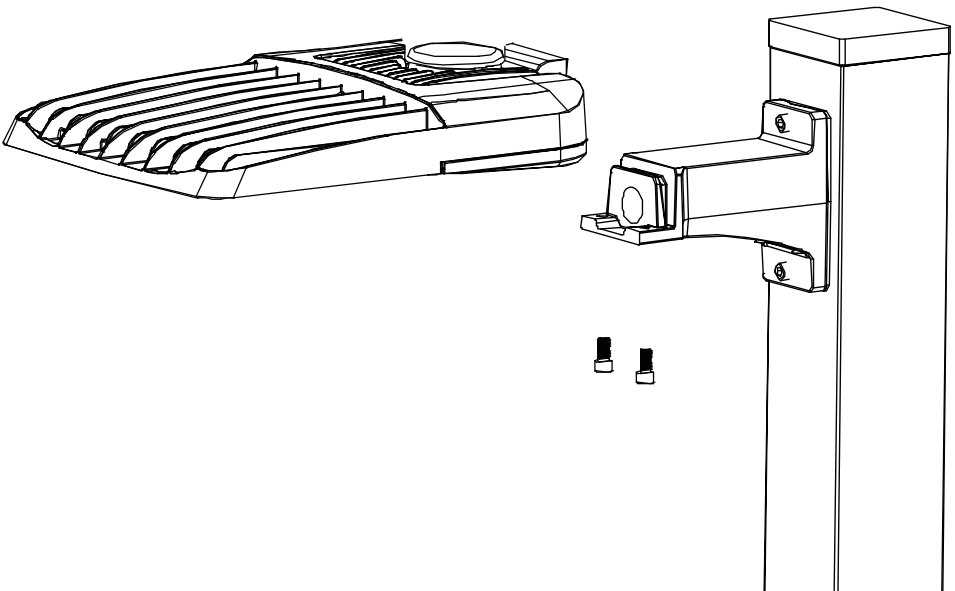

3. Open lower cover of the extruded arm and complete wiring. Use suitable waterproof cord bushing and outlet box cover to maintain IP rating.

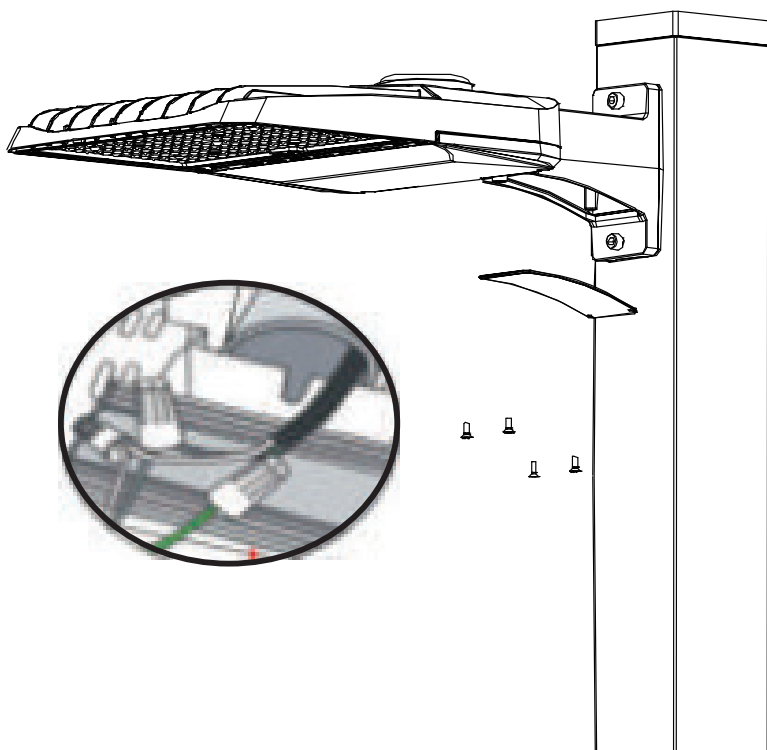

4. Switch on the power supply.

Selectable Power Switch

1. Switch off the power supply.

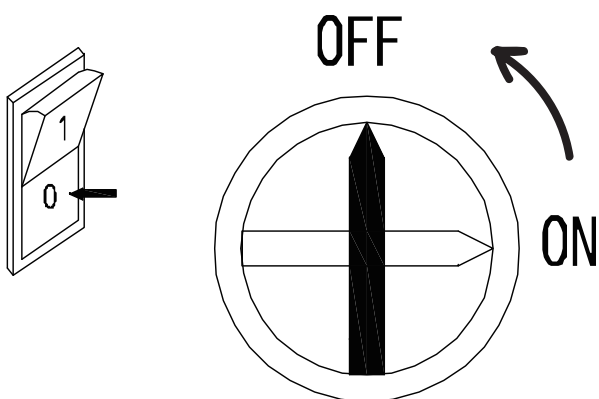

2. Remove the two screws from the LED driver compartment door and remove the cover.

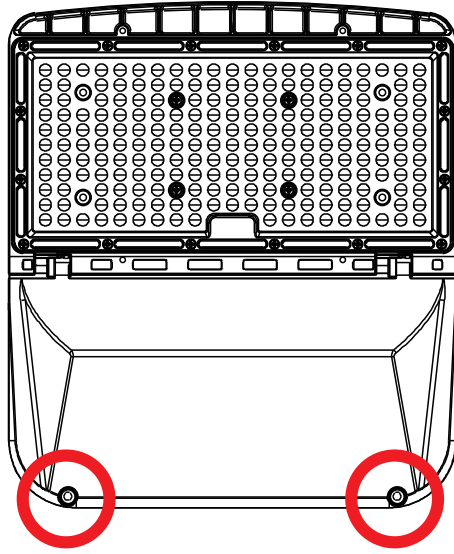

2. Adjust the output wattage by moving the toggle switch to the desired power.

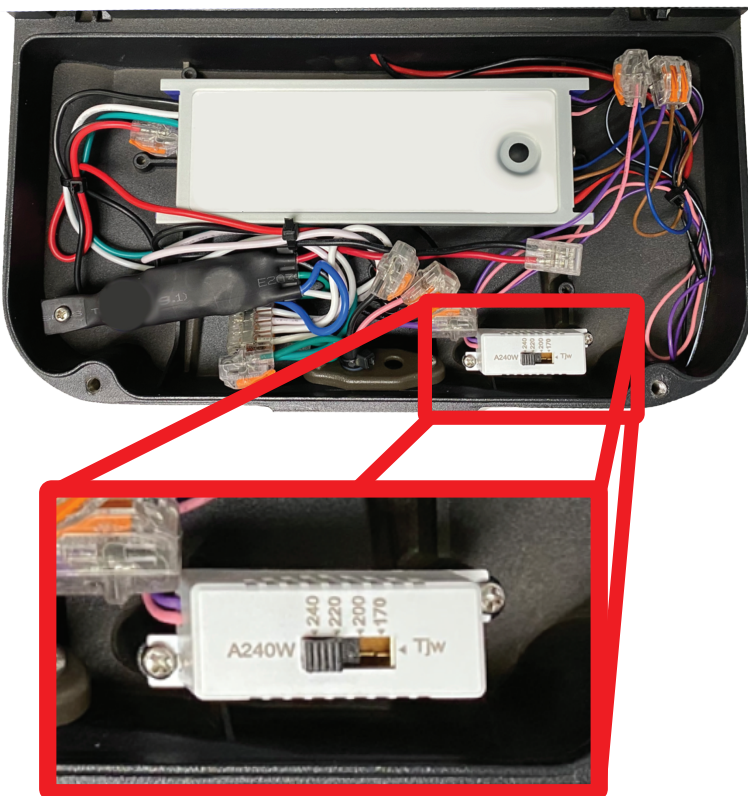

Model #	Input Power (W)	Input Current (A)@Input Voltage (V)
ALJ-2X	80	0.66@120 / 0.28@347
	100	0.77@120 / 0.31@347
	120	0.94@120 / 0.37@347
	150	1.23@120 / 0.45@347
ALJ-4X	180	1.38@120 / 0.61@347
	200	1.63@120 / 0.68@347
	220	1.78@120 / 0.72@347
	240	1.97@120 / 0.78@347

3. Ensure that all gaskets, washers, and brackets are in place before closing and re-screwing the LED driver compartment door. Switch on the power supply.

WIRING DIAGRAM

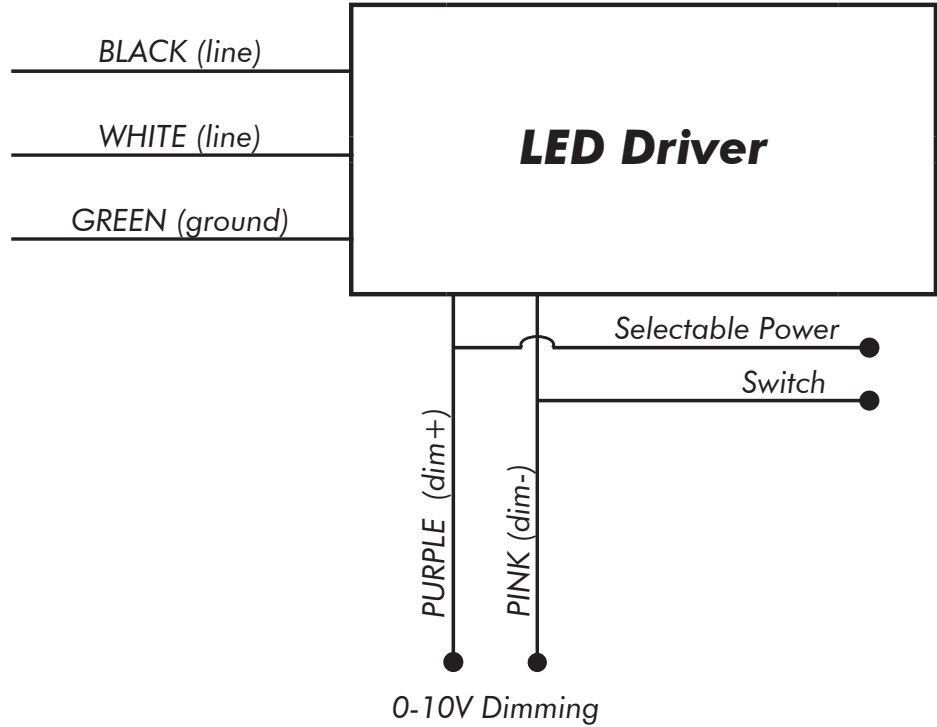

VISOR INSTALLATION

1. Fix the visor on the fixture by putting screws on the four holes provided.

Visor Position 1

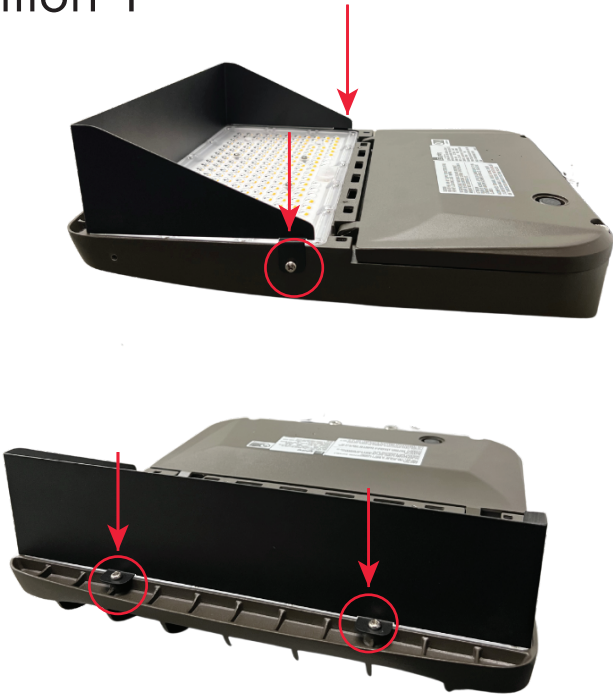

Visor Position 2

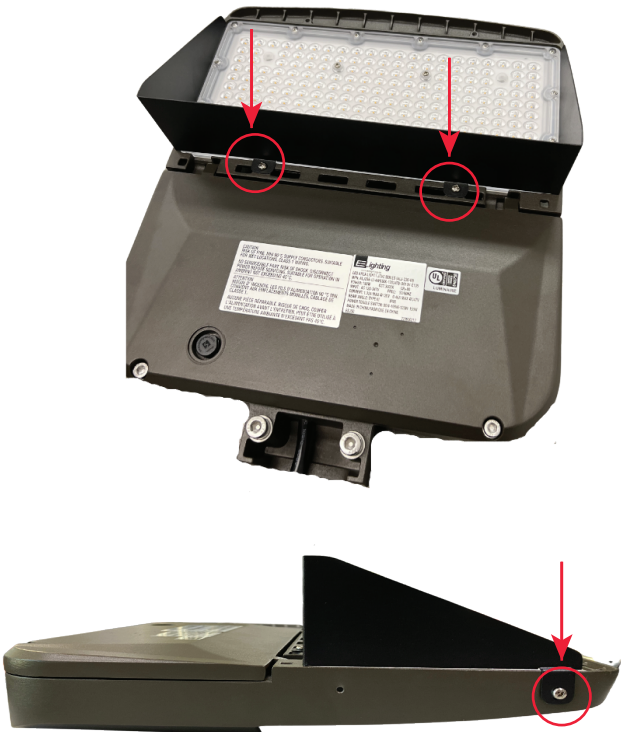



WARNING: Risk of electrical shock.

Make sure the power supply is OFF before installing or maintaining the fixture. Never perform maintenance or cleaning while the fixture is powered. Disconnect the power and ensure the fixture is cool before maintaining.

GENERAL:

This product must be installed in accordance with the applicable installation code by a qualified licensed electrician. Fixtures must be wired in accordance with the National Electrical Code and all applicable local codes. Proper grounding is required for safety. Make sure the input voltage of the fixture is the same as the supply voltage.

DO NOT INSTALL DAMAGED PRODUCT!

This luminaire has been properly packed so that no parts should be damaged during transit. Thoroughly inspect the fixture for any freight damage. Report any freight damage to the delivery carrier.